



AU-POG

SPECIFICATION

LIGHT SOURCE LED

COLOR	: AMBER
QUANTITY	: 188 PCS. 5MM.
LUMINOUS INTENSITY	: 940,000 MCD.
LIFE TIME	: UP TO 100,000 HOURS
FLASHING RATE	: CAN BE ADJUSTED IN 5 STEP 15-35 TIME/MINUTE
EFFECTIVE RANGE	: 1,000 M. LINE OF SIGHT

SOLAR MODULE

TYPE	: MONO CRYSTALLINE SOLAR MODULE
MAX. POWER	: 5W.
MAX. POWER VOLTAGE	: 18V.
MAX. POWER CURRENT	: 277 mA.

BATTERY

TYPE	: SEALED LEAD ACID BATTERY
MAX. POWER VOLTAGE	: 12V.
MAX. POWER CURRENT	: 7.5 Ah/20 HR

ENERGY MANAGEMENT SYSTEM

OPERATION CAPACITY W/O SOLAR CHARGING : 5 DAYS

ENVIRONMENTAL

AMBIENT TEMPERATURE RANGE : -30°C TO + 85°C

LENS

TYPE	: POLYCARBONATE
SIZE	: 275 MM. DIAMETER
COLOR	: CLEAR
PROTECTION	: IP65
WEIGH	: 8.0 KG.

FEATURES

- : BUILT-IN SOLAR PANEL WITH FULLY AUTOMATIC RECHARGEABLE SYSTEM.
- : SUPER BRIGHT LED LAMP ADOPTED PROVIDES HEIGHTER VISIBILITY.
- : FINE LOOKING POWDER COAT STEEL HOUSING AND ENVIRONMENT-FRIENDLY.
- : EASY INSTALLATION. ONCE INSTALLED, MAINTENANCE-FREE LIGHTS OPERATE FOR YEARS WITH OUT BATTERY OR BULB REPLACEMENT OR SERVING.

WARRANTY

- : 3 YEARS LED LAMPS & SOLAR CELL
- : 1 YEAR BATTERY

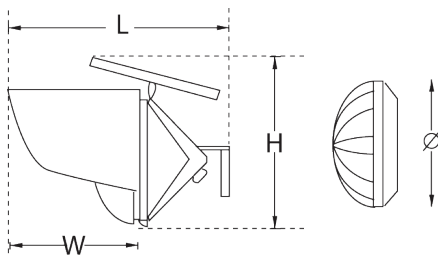

MODEL	DIMENSION(mm.)				SOLARCELL + BATTERY
	L	W	H	∅	
AU-POW-001	480	280	372	272	/
AU-POW-002	480	280	295	272	X

WIRES

<input type="checkbox"/> THW	<input type="checkbox"/> 70°C	<input type="checkbox"/> 0.5 SQmm.	<input type="checkbox"/> 13 AWG
<input type="checkbox"/> UL STYLE & CSA TYPE	<input type="checkbox"/> 90°C	<input type="checkbox"/> 1.0 SQmm.	<input type="checkbox"/> 15 AWG
<input type="checkbox"/> HEATER WIRE	<input type="checkbox"/> 105°C	<input type="checkbox"/> 1.5 SQmm.	<input type="checkbox"/> 17 AWG
<input type="checkbox"/> OTHER	<input type="checkbox"/> 200°C	<input type="checkbox"/> 2.5 SQmm.	<input type="checkbox"/> 20 AWG