

AUF XP4

SPECIFICATION

<p>HOUSING : COPPER FREE ALUMINIUM EXCEPT SHEET ALUMINIUM ALLOY</p> <p>SURFACETREATMENT : ION-PHOSPHATE AND ANTI-RUST FINISHED WITH UV RESISTANT WHITE POLYESTER POWDER COAT</p> <p>REFLECTOR : PARABOLIC HIGH PURITY ANODIZED ALUMINIUM 99.85% MIRROR</p> <p>GUARD : STAINLESS STEEL</p> <p>DIFFUSER : GLASS "PYREX" BRAND TUBING AND MADE IN USA. BIRROCILICATE GLASS, HEAT AND IMPACT RESISTANT</p> <p>WIRES : THW, TIS.11-1988 STANDARD</p> <p>LAMP HOLDER : ROTOR LOCKED TYPE HIGH-HEAT RESISTANT, TIS344-1987 STANDARD</p> <p>BALLAST : ELECTRONIC BALLAST, HIGH POWER FACTOR (P.F.>0.95)</p> <p>PROTECTION CLASS : PROTECTION CLASS EQUIVALENT TO IP 66/67 (ACC. TO EN60529/IEC60529) : CLASS I, DIV.I,II GROUPS C, D</p>	<p>CERTIFICATION NUMBER : CLASS I, DIV.I,II GROUPS E, F, G : CLASS III : TIS 1955-1999 : TIS 902-1989</p> <p>COMPLIANCES : UL STANDARD 844, 1570 : NEC. CLASS I, DIV.I,II GROUPS C, D : NEC. CLASS II, GROUPS E, F, G</p> <p>INSTALLATION : SURFACE OR SUSPEND MOUNT</p> <p>APPLICATION : USE INSIDE PAINT SPRAY BOOTHS WHERE HAZARDOUS FUMES, GASES, OIL REFINERIES, PETROCHEMICAL PLANTS, PAINT MANUFACTURING PLANTS FLOUR MILLS, AND PAINT RESIDUE ARE PRESENT THIS INCLUDES POEDER PAINT PROCESS AREAS.</p> <p>COMPLETE SET* : INCLUDING ELECTRONIC BALLAST, LAMP</p>
--	--

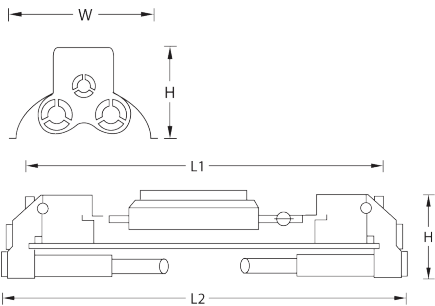

MODEL	LAMP	DIMENSION(mm.)				WEIGHT (kg.)
		L1	L2	W	H	
AUF XP4-120	1 x 18W. T8	593	668	265	210	11.60
AUF XP4-220	2 x 18W. T8	598	673	265	210	15.60
AUF XP4-140	1 x 36W. T8	1200	1350	265	210	14.20
AUF XP4-232	2 x 32W. T8	1200	1350	265	210	18.70
AUF XP4-240	2 x 36W.T8	1200	1350	265	210	18.70

INSTALLATION : SURFACE OR SUSPEND MOUNT